

PARTS MAIN FRAME ASSEMBLY

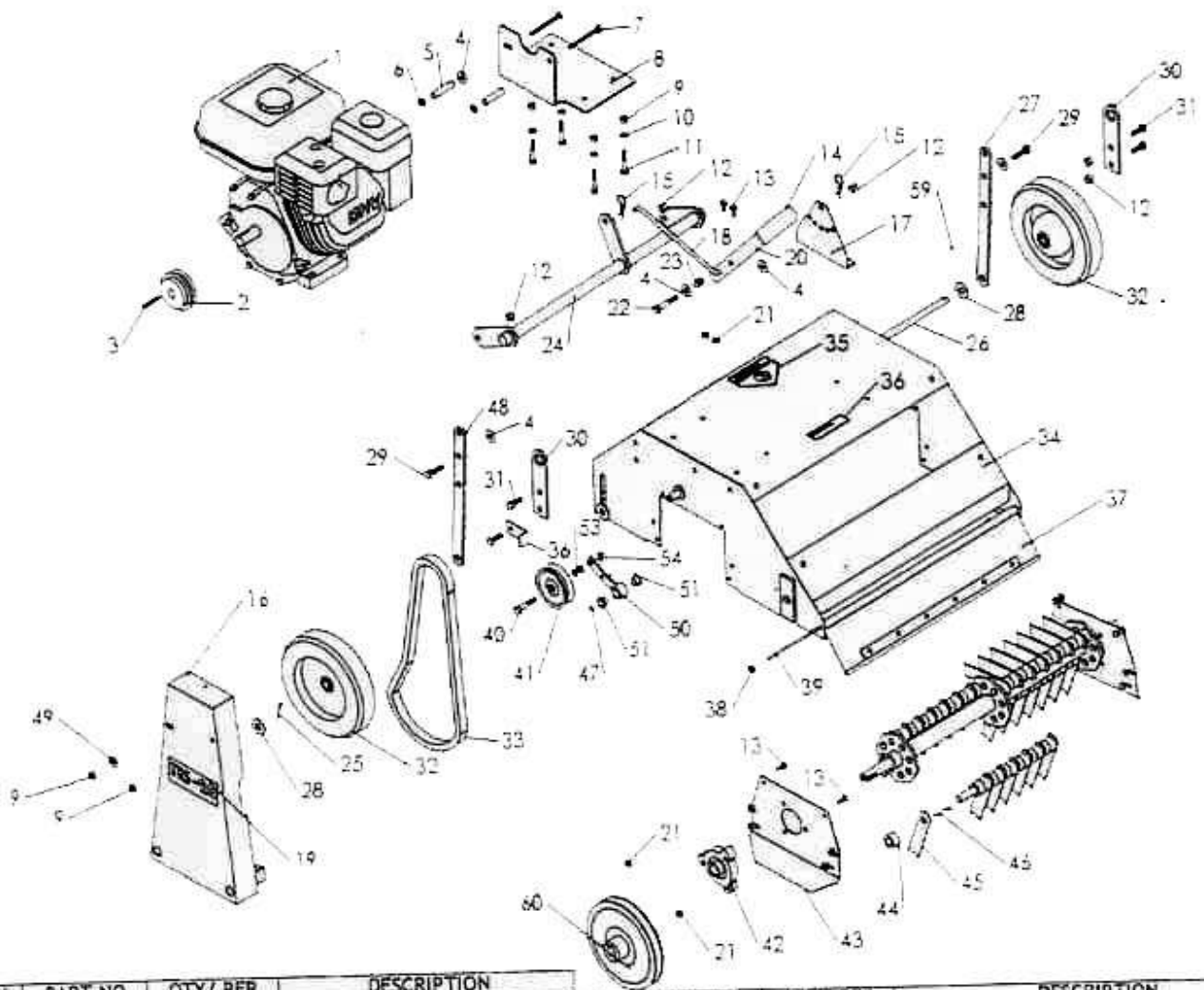

| KEY | PART NO | QTY/ PER SHEET | DESCRIPTION | KEY | PART NO | QTY/ PER SHEET | DESCRIPTION |
|-----|---------|----------------|--------------------------------|-----|---------|----------------|--------------------------------------|
| 1 | 100137 | 1 | 5.5 HP HONDA ENGINE | 31 | 500043 | 4 | 3/8-16 x 1 BOLT |
| 1 | 100051 | 1 | B&S INTEC ENGINE | 32 | 100064 | 2 | 8" FRONT WHEEL & TIRE ASSEMBLY |
| 2 | 100057 | 1 | SHEAVE w/o KEY, 3.15x.750 BORE | 33 | 100065 | 1 | RAKE BELT |
| 3 | 500090 | 1 | 3/16 x 1-3/4 SQ. MACHINE KEY | 34 | 400118 | 1 | MAIN FRAME |
| 4 | 500042 | 3 | 3/8 FLAT WASHER | 35 | 100069 | 1 | DECAL, "DANGER" |
| 5 | 300029 | 2 | 5/16 x 2 SPACER | 36 | 100071 | 1 | DECAL, "BAIL ENGAGEMENT" |
| 6 | 500085 | 2 | 5/16-18 x WHIZ LOCK NUT | 37 | 300015 | 1 | DRAG SHIELD ASSEMBLY |
| 7 | 500086 | 2 | 5/16-18 x 3 TAP BOLT | 38 | 500082 | 2 | 3/16 NYLOC NUT |
| 8 | 300012 | 1 | ENGINE PAD | 39 | 300028 | 1 | 3/16 ALL THREAD ROD |
| 9 | 500072 | 6 | 5/16-18 x NYLOC NUT | 40 | 500079 | 1 | 3/8-16 x 1-3/4 BOLT |
| 10 | 500115 | 4 | 5/16 LOCK WASHER | 41 | 100072 | 1 | FLAT IDLER w/ FLANGES |
| 11 | 500074 | 4 | 5/16-18 x 1-3/4 BOLT | 42 | 100050 | 2 | FLANGE BEARING |
| 12 | 500076 | 6 | 3/8-16 NYLOC | 43 | 300013 | 2 | PLATE END |
| 13 | 500069 | 12 | 1/4-20 x 5/8 BOLT | 44 | 100056 | 52 | FINGER SPACER |
| 14 | 100007 | 1 | RUBBER GRIP | 45 | 300019 | 28 | RAKE FINGER |
| 15 | 500092 | 2 | HAIR PIN | 46 | 500067 | 8 | 1/8 x 7/8 ROLL PIN |
| 16 | 400032 | 1 | BELT SHIELD | 47 | 500078 | 1 | E RING |
| 17 | 300017 | 1 | HEIGHT ADJUSTMENT PLATE | 48 | 300034 | 1 | L.H. SEED BOX SUPPORT |
| 18 | 300026 | 1 | HEIGHT ADJUSTMENT ROD | 49 | 500083 | 1 | 5/16 FLAT WASHER |
| 19 | 100328 | 1 | DECAL, "TRS-20" | 50 | 400035 | 1 | ENGAGEMENT ARM w/ STEEL BUSHING |
| 20 | 300016 | 1 | HEIGHT ADJUSTMENT LEVER | 51 | 100052 | 2 | BEARING CONTROL |
| 21 | 500068 | 14 | 1/4-20 x NYLOC NUT | 52 | 300036 | 1 | ENGAGEMENT ARM STOP |
| 22 | 500091 | 1 | 3/8-16 x 2 BOLT | 53 | 300030 | 2 | BUSHING STRUT |
| 23 | 500065 | 1 | COMPRESSION SPRING | 54 | 500081 | 1 | 3/8-16 x WHIZ LOCK NUT |
| 24 | 400033 | 1 | CRANK ASSEMBLY | 55 | 100061 | 1 | DECAL, "CAUTION" (NOT SHOWN) |
| 25 | 500062 | 2 | 1/8 x 1-1/4 COTTER PIN | 56 | 100070 | 1 | DECAL, "DANGER CO2" (NOT SHOWN) |
| 26 | 300027 | 1 | FRONT AXLE | 57 | 100060 | 1 | DECAL, "CAUTION MUFFLER" (NOT SHOWN) |
| 27 | 300035 | 1 | R.H. SEED BOX SUPPORT | 58 | 100073 | 1 | LUBRICATION TAG (NOT SHOWN) |
| 28 | 500034 | 2 | 1/2 FLAT WASHER | 59 | 500056 | 1 | 10-28 SET SCREW |
| 29 | 500134 | 2 | 3/8-16 x 1-1/4 BOLT | 60 | 100058 | 1 | 7" PULLEY |
| 30 | 300018 | 2 | HEIGHT MOUNT ADJUSTMENT | | | | |

PARTS SELF PROPELLED ASSEMBLY

attache rapide
ref 100025

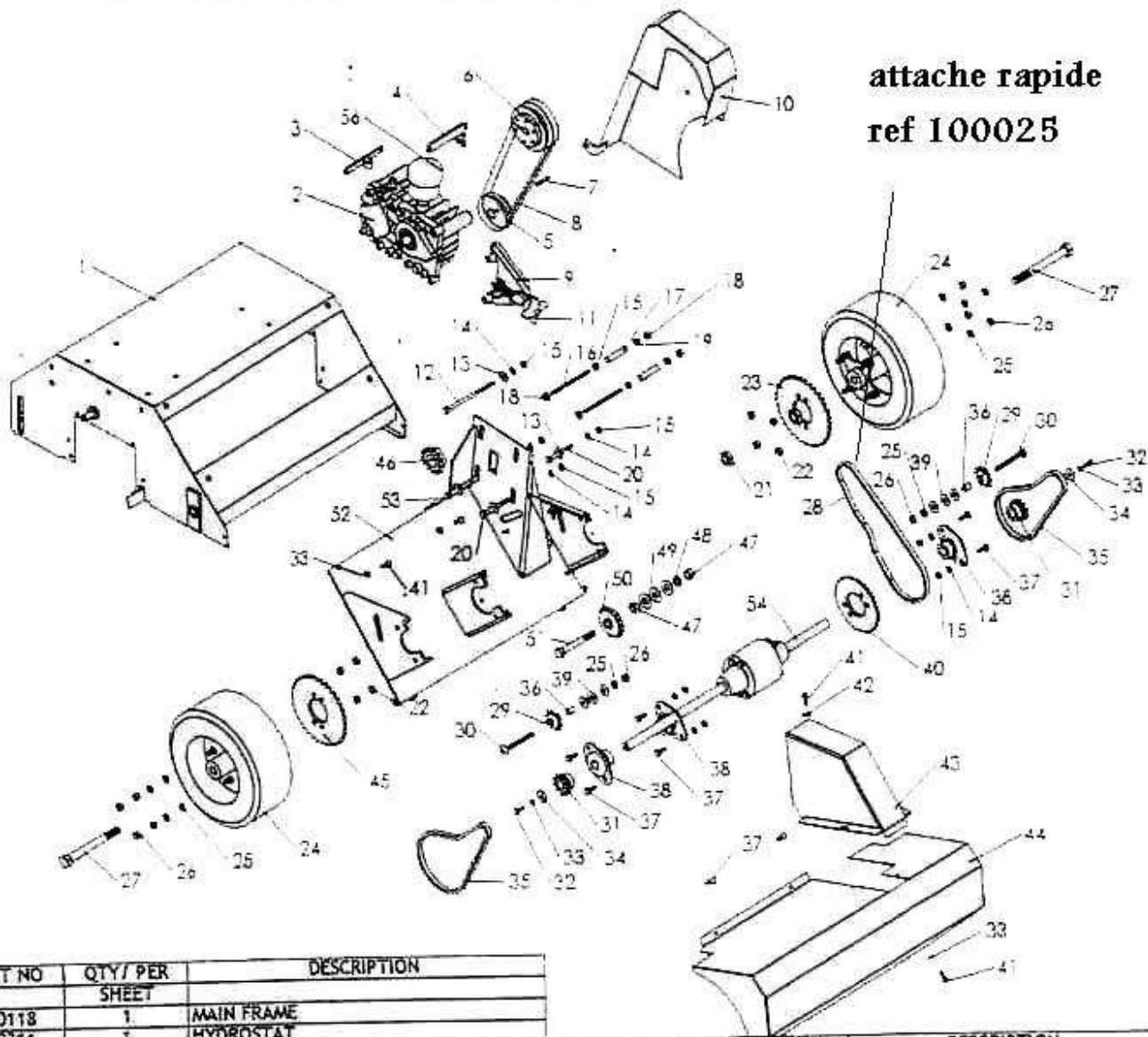

| KEY | PART NO | QTY/ PER SHEET | DESCRIPTION |
|-----|---------|----------------|-------------------------------------|
| 1 | 400118 | 1 | MAIN FRAME |
| 2 | 100311 | 1 | HYDROSTAT |
| 3 | 400163 | 1 | SHIFTER MOUNT |
| 4 | 400162 | 1 | CABLE MOUNT |
| 5 | 100057 | 1 | SHEAVE w/o KEY, 3.15x.750 BORE |
| 6 | 100315 | 1 | 1B 34 PULLEY |
| 7 | 500011 | 1 | 3/16 x 1 SQUARE KEY |
| 8 | 100323 | 1 | BX30 V-BELT |
| 9 | 400186 | 1 | HYDROLIC BY-PASS |
| 10 | 400165 | 1 | PULLEY GUARD |
| 11 | 100059 | 1 | FOUR PRONG KNOB |
| 12 | 500219 | 1 | 5/16 x 5 BOLT |
| 13 | 500083 | 5 | 5/16 FLAT WASHER |
| 14 | 500115 | 14 | 5/16 LOCK WASHER |
| 15 | 500101 | 14 | 5/16-18 NUT |
| 16 | 300111 | 2 | 5/16 THREADED ROD |
| 17 | 300029 | 2 | 5/16 x 2 SPACER |
| 18 | 500072 | 2 | 5/16-18 NYLOC NUT |
| 19 | 500085 | 2 | 5/16-18 WHIZ LOCK NUT |
| 20 | 500143 | 2 | 5/16-18 x 2-1/2 BOLT |
| 21 | 500077 | 2 | 5/8-18 JAM NUT |
| 22 | 500041 | 8 | 3/8-24 LOCK NUT |
| 23 | 200041 | 2 | 48 TOOTH SPROCKET |
| 24 | 100316 | 2 | REAR WHEEL |
| 25 | 500130 | 2 | 3/8 LOCK WASHER |
| 26 | 500129 | 2 | 3/8-16 NUT |
| 27 | 500220 | 2 | 5/8 x 5-1/2 BOLT |
| 28 | 100325 | 1 | CHAIN, 54 ROLLERS |
| 29 | 200042 | 2 | 10 TOOTH IDLER SPROCKET |
| 30 | 500166 | 2 | 3/8-16 x 3 ALL THREAD CARRIAGE BOLT |

| KEY | PART NO | QTY/ PER SHEET | DESCRIPTION |
|-----|---------|----------------|------------------------------|
| 31 | 200043 | 2 | 10 TOOTH SPROCKET |
| 32 | 500071 | 2 | 1/4-28 x 5/8 BOLT |
| 33 | 500137 | 8 | 1/4 LOCK WASHER |
| 34 | 500164 | 2 | 1/4 FENDER WASHER |
| 35 | 100324 | 2 | CHAIN, 58 ROLLERS |
| 36 | 300110 | 2 | 1/2 x 5/8 SPACER |
| 37 | 500140 | 10 | 5/16-18 x 3/4 BOLT |
| 38 | 100247 | 3 | 3/4 2-BOLT BEARING w/COLLAR |
| 39 | 500042 | 4 | 3/8 FLAT WASHER |
| 40 | 200045 | 1 | 40x30 SPROCKET |
| 41 | 500029 | 6 | 1/4-20 x 3/4 BOLT |
| 42 | 500088 | 6 | 1/4 FLAT WASHER |
| 43 | 400164 | 1 | SMALL GUARD |
| 44 | 400178 | 1 | LARGE GUARD |
| 45 | 200041 | 1 | 40x30 SPROCKET |
| 46 | 200044 | 1 | 13 TOOTH SPROCKET |
| 47 | 500106 | 1 | 1/2-13 NUT |
| 48 | 500006 | 1 | 1/2 LOCK WASHER |
| 49 | 500034 | 2 | 1/2 FLAT WASHER |
| 50 | 100043 | 1 | #40x17x1/2 IDLER SPROCKET |
| 51 | 500158 | 1 | 1/2-13 x 3-1/2 BOLT |
| 52 | 400161 | 1 | HYDRO/DIFFERENTIAL MOUNT |
| 53 | 500168 | 1 | 5/16-18 x 4-1/2 BOLT |
| 54 | 100322 | 1 | TRANSAXLE |
| 55 | 100074 | 2 | DECAL, "CLASSEN" (NOT SHOWN) |
| 56 | 100339 | 1 | HYDROSTAT RESEVOIR |

PARTS HANDLE ASSEMBLY

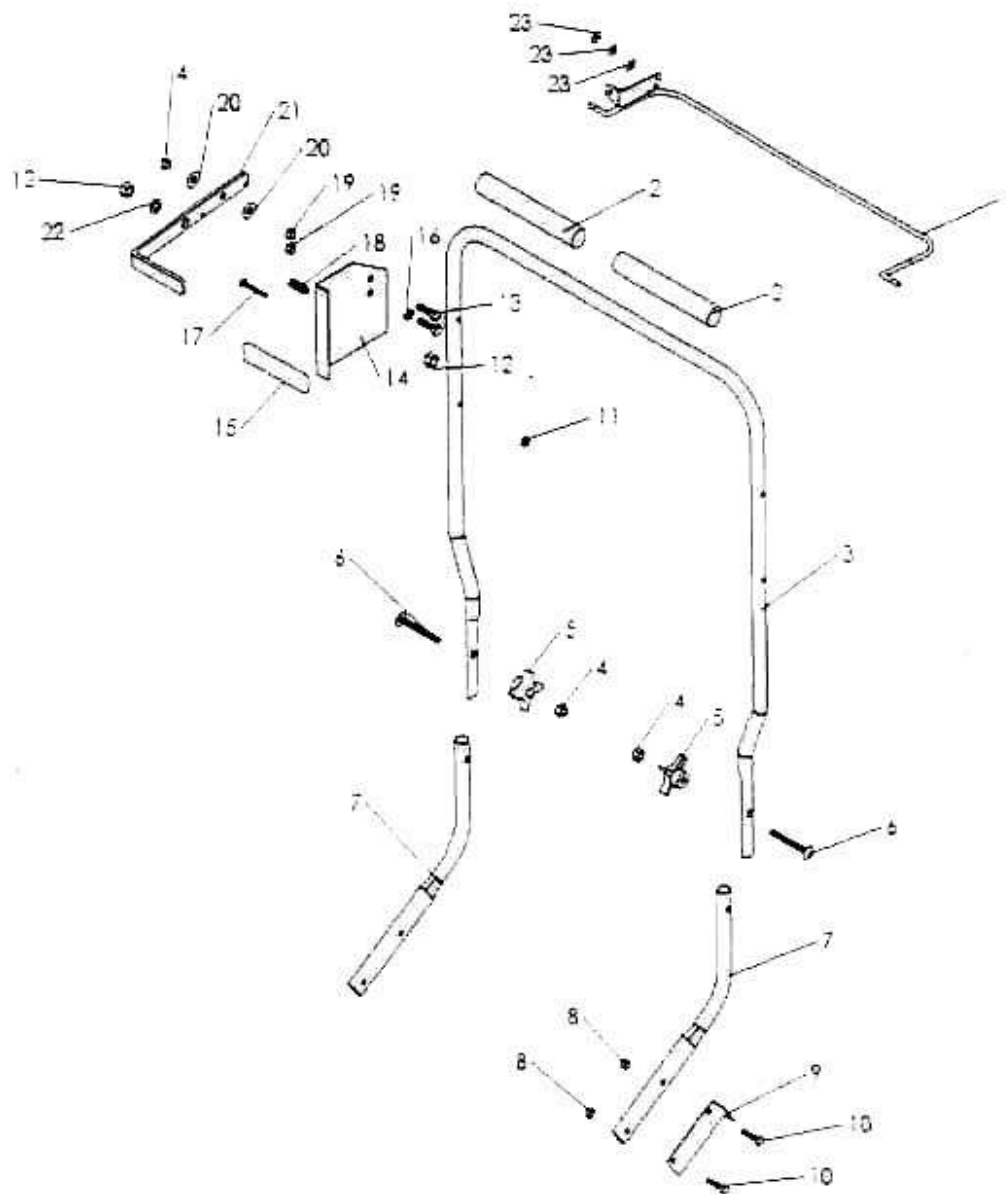

| KEY | PART NO | QTY/ PER | DESCRIPTION |
|-----|---------|----------|------------------------------------|
| 1 | 400034 | 1 | Engagement Ball |
| 2 | 100261 | 2 | Handle Grips |
| 3 | 300023 | 1 | Main Handle |
| 4 | 500167 | 2 | 3/8" Lock Nut |
| 5 | 100059 | 2 | Four Prong Knobs |
| 6 | 500166 | 2 | 3/8" x 3" All Thread Carriage Bolt |
| 7 | 300022 | 2 | Lower Handle |
| 8 | 500072 | 4 | 5/16" Nyloc Nut |
| 9 | 300024 | 1 | Clutch Cable Bracket |
| 10 | 500073 | 4 | 5/16" x 1 1/4" Bolt |
| 11 | 500068 | 1 | 1/4" Nyloc Nut |
| 12 | 500106 | 1 | 1/2" Nut |
| 13 | 500134 | 2 | 3/8" x 1 1/4" Bolt |
| 14 | 300109 | 1 | Speed Gauge Lever |
| 15 | 100007 | 1 | Rubber Grip |
| 16 | 500130 | 1 | 3/8" Lock Washer |
| 17 | 500118 | 1 | 1/4" x 1 3/4" Bolt |
| 18 | 100326 | 1 | Plunger |
| 19 | 500129 | 2 | 3/8" Nut |
| 20 | 500042 | 2 | 3/8" Flat Washer |
| 21 | 300108 | 1 | Speed Lever |
| 22 | 500006 | 1 | 1/2" Lock Washer |
| 23 | 500088 | 3 | 1/4" Flat Washer |
| 24 | 100327 | 2 | Shifter Cable (Not Shown) |
| 25 | 100053 | 1 | Throttle Cable (Not Shown) |

SEEDER / MULTIPURPOSE BLADE ASSEMBLY

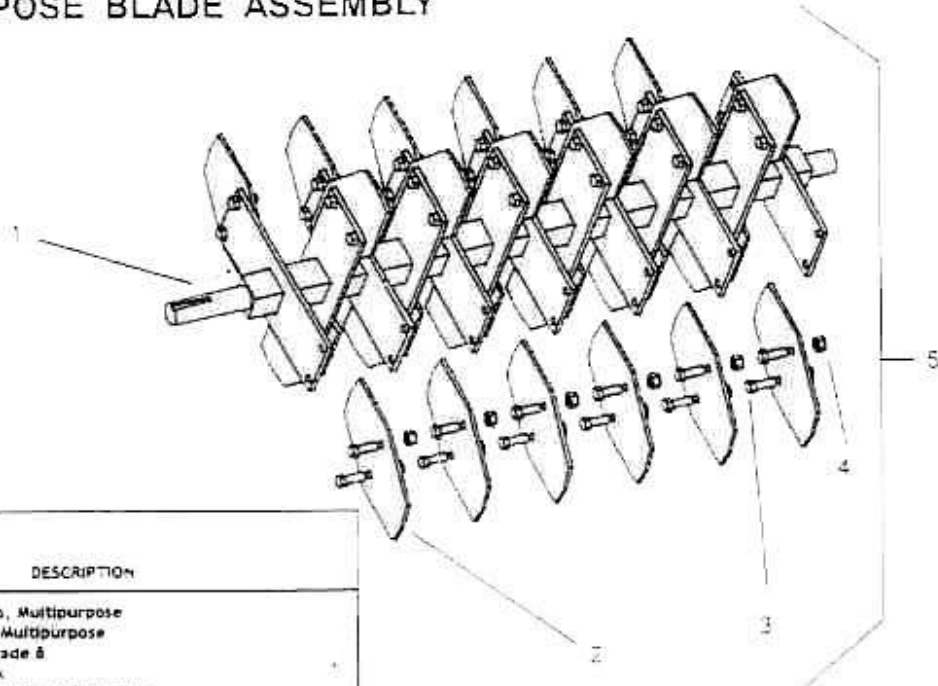

| KEY | PART NO. | QTY PER MACH | DESCRIPTION |
|-----|----------|--------------|--|
| 1 | 700025 | 1 | Shaft w/ Blade Holders, Multipurpose |
| 2 | 100310 | 26 | Blade w/5/16" Holes, Multipurpose |
| 3 | 500216 | 52 | Bolt, 5/16-18 x 3/4 Grade 8 |
| 4 | 500217 | 52 | Nut, 5/16-18 Top Lock |
| 5 | 600030 | 1 | Shaft/Blades Sub-Assembly, Multipurpose |
| 6 | 900026 | 1 | Complete Shaft Assembly (Includes Blades, End Plates, Bearings, Pulley, Key & Fasteners, Multipurpose) - Not Shown |

SLICER BLADE ASSEMBLY (Optional)

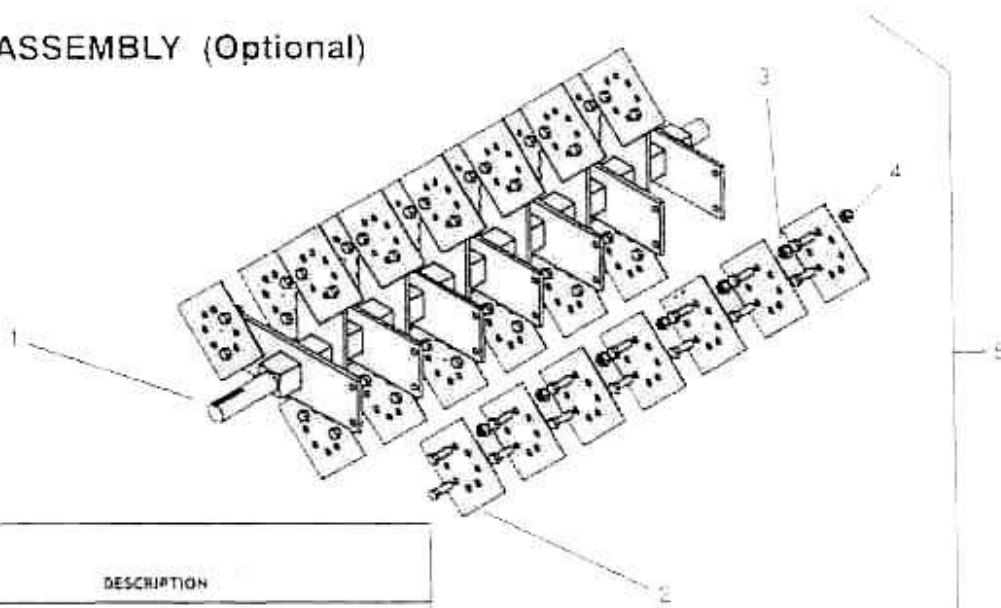

| KEY | PART NO. | QTY PER MACH | DESCRIPTION |
|-----|----------|--------------|--|
| 1 | 700025 | 1 | Shaft w/ Blade Holders, Multipurpose |
| 2 | 300032 | 26 | Blade, Slicer Square |
| 3 | 500216 | 52 | Bolt, 5/16-18 x 3/4 Grade 8 |
| 4 | 500217 | 52 | Nut, 5/16-18 Top Lock |
| 5 | 600040 | 1 | Shaft/Blades Sub-Assembly, Multipurpose |
| 6 | 900027 | 1 | Complete Shaft Assembly (Includes Blades, End Plates, Bearings, Pulley, Key & Fasteners, Multipurpose) - Not Shown |